

1. ELV's stacked 2 high - approx 200m³
2. ELV's stacked 2 high - approx 100m³
3. ELV's - approx 40m³
4. 5 x IBC's - parts - approx 5m³
5. Car body panels / bumpers- wall mounted - approx 10 x 1 x 1 = 10m³
6. Pallets - gear boxes - approx 5 x 1 x 1 = 5m²
7. 4 x IBC's - parts - approx 4m³
8. ELV approx 10m³
9. ELV depollution stillages = approx 20m²
10. 40 cyd skip - tyres
11. 11 x Battery boxes - cables = approx 11m³
12. 10 x Battery boxes - non ferrous = approx 10m³
13. 11 x40 cyd Ro Ro's - metal scrap = 440m³
14. Stock pile - steel - approx 10.4 x 15.6 x 3 = 470m³
15. Stock pile - steel - approx 10.7 x 16 x 3 = 504m³
16. Stock pile - steel - approx 10.5 x 6 x 3 = 174m³
17. Battery shed max 25 battery box's = approx 25m³
18. ELV storage = approx 60m³
19. ELV storage = approx 60m³
20. ELV storage = approx 60m³
21. ELV storage = approx 60m³
22. IBC's - alloy wheels = approx 5m³
23. ELV depollution stillage = approx 10m³
24. Body panels - approx 5 x 1 x 1 = 5m³
25. Racking - tyres - approx 5 x 1 x 1 = 5m³
26. 12 x Battery Boxes - Non ferrous = approx 12m³

Shed 1 - Concrete floor, 3m high brick wall building
 Shed 2 - Concrete floor, 4m high brick wall
 Shed 3 - Concrete floor, 2m & 3m high brick wall
 Shed 4 - Concrete floor, steel building

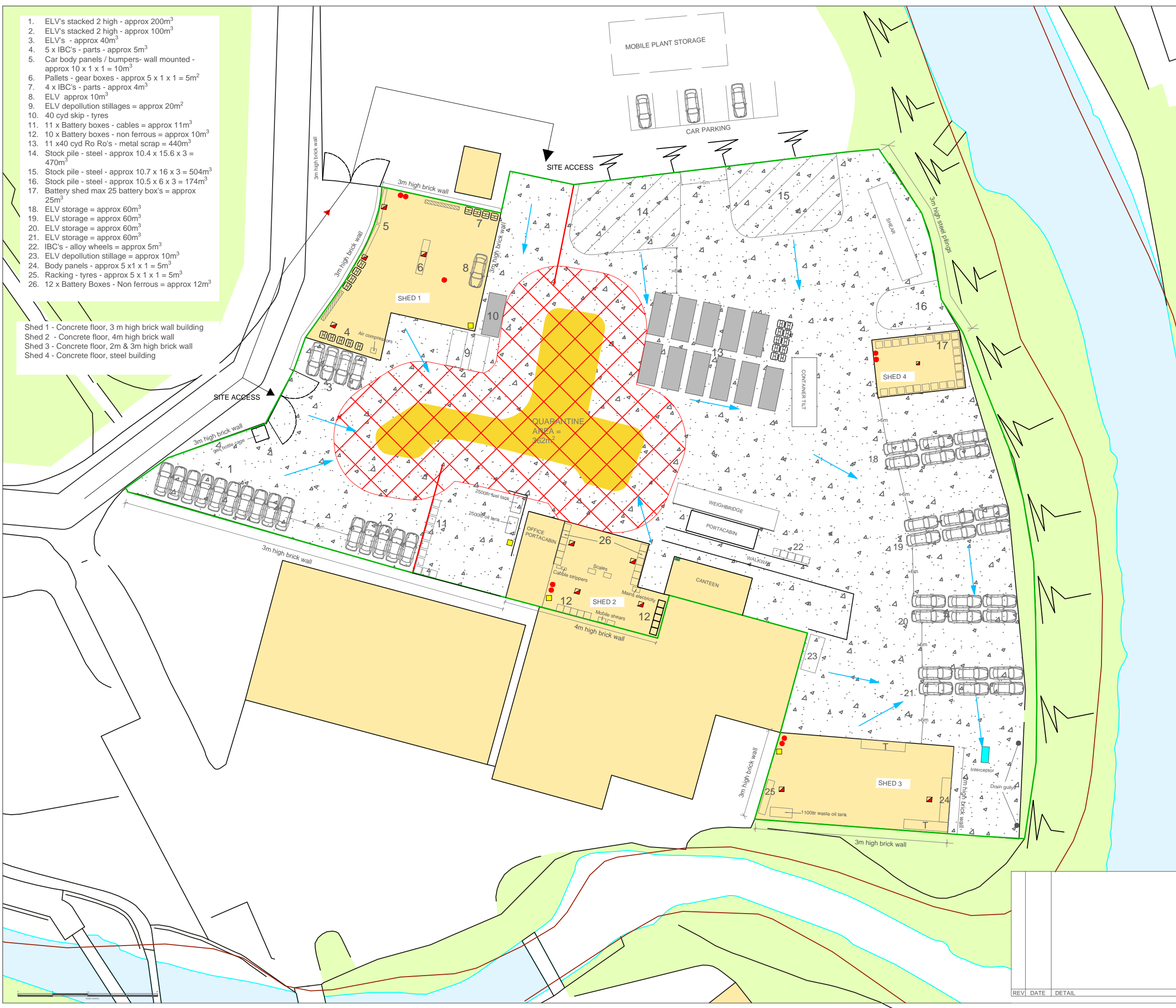

- PPE Storage
- Spill Kits
- Automatic Fire extinguishers
- Concrete surface
- Fire extinguishers
- Fire wall
- Quarantine area showing a 6m buffer zone

CLIENT
LLOYDS METALS

SITE
 Raikes clough industrial estate,
 Aqueduct road
 Haulgh
 Bolton
 BL3 1RP

PROJECT PERMIT APPLICATION			
TITLE ENVIRONMENTAL MANAGEMENT PLAN			
SCALE @A3 1:500	DATE MAY 2020	DRAWN BY T Kearns	CHECKED BY D Alcock
DRAWING NO 200401LM104		REVISION	

REV. DATE DETAIL