

SZ09NE/ 34 ASSET MAP

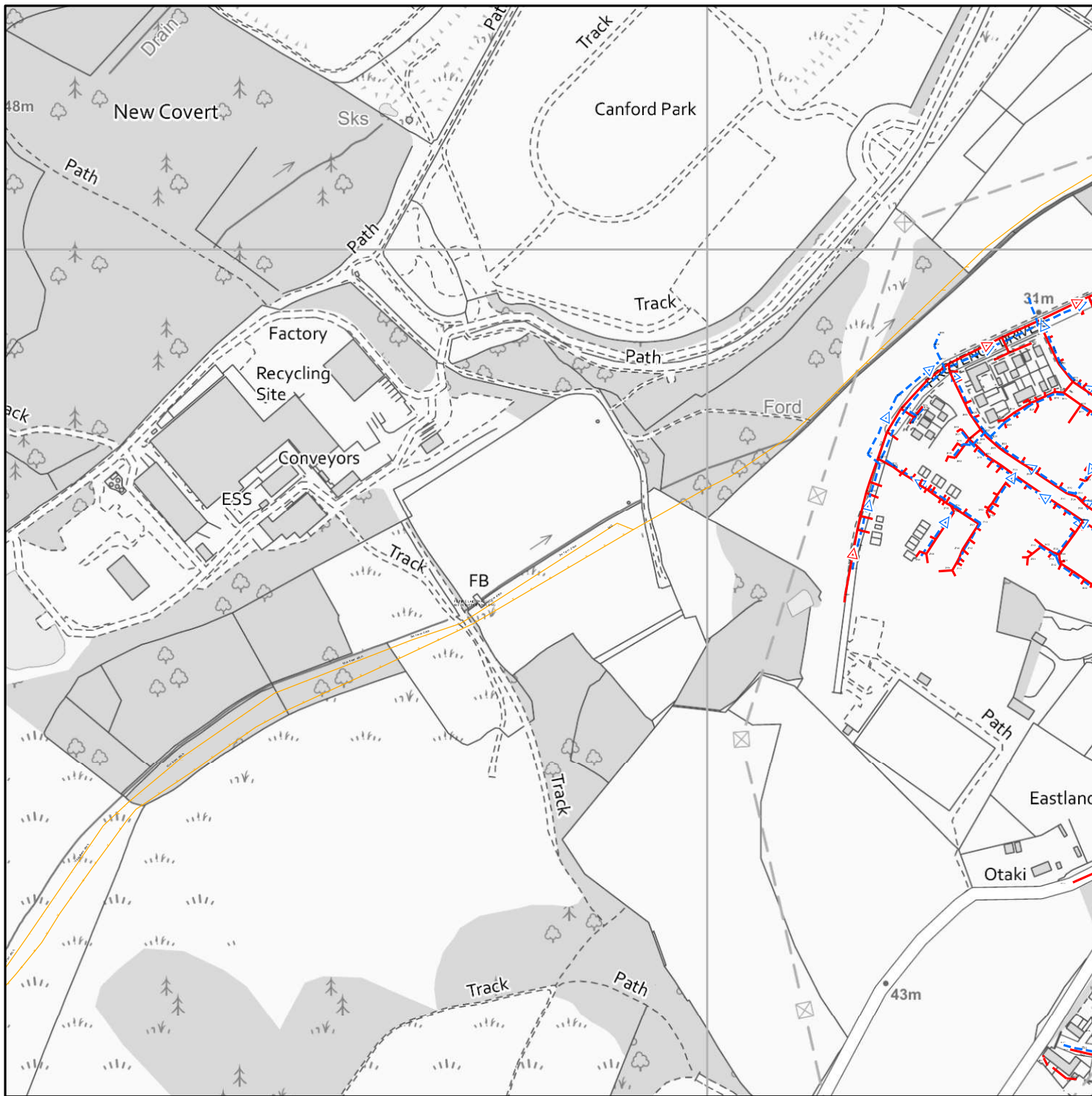

Reproduced from the Ordnance Survey map by permission on behalf of the Controller of Her Majesty's Stationery Office © Crown Copyright . Licence 100019539.

WATER MAINS	SEWERS	PUBLIC PRIVATE SECTION 104	OTHER WESSEX PIPES	NON-WESSEX / UNKNOWN
Distribution Main	Foul	Surface	Rising Mains	Private Rising Mains
Washout Main	Combined	Abandoned	Standby Rising Mains	Culverted Watercourse
Raw Water Main	Abandoned	Abandoned	EDM	Highway Drain
Abandoned Main			Overflow	Use Unknown
Private Main			Syphon	Status Unknown
SITES	STRUCTURES	OTHER STRUCTURES	OTHER STRUCTURES	OTHER STRUCTURES
Source	Manhole - Foul	Pumping Station - Surface	Attenuation Tank	Chamber
Reservoir	Manhole - Surface	Pumping Stn - Foul/Combined	Storage Tank	Tunnel
Pump	Manhole - Combined	Gully		Interceptor
Treatment Works	Outfall	Vent Column		
FITTINGS	Inlet	Rodding Eye		
Valve - Open	Lamphole	Catchpit		
Valve - Closed	Bifurcation - Foul	Flushing Chamber		
Fire Hydrant	Bifurcation - Surface	Soakaway		
Pressure Reducing Valve	Bifurcation - Combined	Non Return Valve		
Meter	Combined Sewage Overflow	Washout		
		Air Valve		
		Hatch Box		

Colours generally indicate the use of the sewer/drain (i.e Red - Foul, Dark Blue - Surface, Magenta - Combined/Dual Use, Light Green - Highway Drain, Mid Green - Overflow) styles of line are shown on the key in sample/typical colours.

Information in this plan is provided for identification purposes only. No warranty as to accuracy is given or implied. The precise route of pipe work may not exactly match that shown. Wessex Water does not accept liability for inaccuracies. Sewers and lateral drains adopted by Wessex Water under the Water Industry (Schemes for Adoption of Private Sewers) Regulations 2011 are to be plotted over time and may not yet be shown. In carrying out any works, you accept liability for the cost of any repairs to Wessex Water apparatus damaged as a result of your works. You are advised to commence excavations using hand tools only. Mechanical digging equipment should not be used until pipe work has been precisely located. If you are considering any form of building works and pipe work is shown within the boundary of your property or a property to be purchased (or very close by) a surveyor should plot its exact position prior to commencing works or purchase. Building over or near Wessex Water's apparatus is not normally permitted.

Date: 03/11/2022, 14:32:04
Scale: 1:5,000
Centre: 403,859, 96,725

From: Ann-Marie Wood <Ann-Marie.Wood@wessexwater.co.uk>
Sent: 03 November 2022 14:37
To: Sean Whelan
Cc: Brendan McCarthy; Lucy Elcoat-Dean
Subject: WW Resp DEV SZ09NE/ 34 - Canford EfW - Pre-planning enquiry - Foul and Supply Capacity
Attachments: SZ09NE_ 34 ASSET MAP.pdf

Dear Sean

Thank you for your enquiry with regards to foul capacity for the proposed Energy From Waste development at Canford Magna.

There is very little public foul network within proximity to the site, the closet public foul sewer of a suitable size being located to the north on Magna Road and feeds into Magna Road Pumping Station, the rising main from which passes along the eastern boundary of the proposed site. There is very limited capacity within the existing network and pumping station and your proposed discharge rate of 6 l/s is a significant volume, equivalent to approximately 130 dwellings, therefore, a capacity appraisal and detailed process review will be required to understand the scope of improvement works necessary to accommodate any additional loading in the system and the pumping station.

At this stage, as this is a commercial development, it is important to make you aware that any capacity appraisal and process review and subsequent off-site reinforcement work necessary to serve commercial developments, including any design work, is not funded through our infrastructure charging arrangements. The liability for these costs lies wholly with the developer.

It is likely that the capacity appraisal and process review will cost in excess of £1,500, if you would like us to proceed with the capacity appraisal and process review, please let us know in writing and we will obtain a confirmation of the cost for this.

I note you have requested water supply on your Planning Liaison Application form, Wessex Water is not the incumbent in this area.

I have attached a map showing the Wessex Water Assets within the vicinity of the site.

I look forward to hearing from you.

Kind regards
Ann-marie

Ann-marie Wood
Senior Planning Liaison Engineer
Wessex Water

Claverton Down Bath BA2 7WW
Mobile number 07385 433347

wessexwater.co.uk

These comments are based upon known circumstances prevailing at the time of writing. A review of the contents of this email is required where 18 months or more have elapsed since issue or in the light of significant changes likely to impact upon the response (e.g. changes in development numbers or phasing). Please email review requests to planning.liaison@wessexwater.co.uk

From: Sean Whelan <sean.whelan@watermangroup.com>
Sent: 02 November 2022 08:49
To: Planning Liaison <planning.liaison@wessexwater.co.uk>
Cc: Brendan McCarthy <brendan.mccarthy@watermangroup.com>; Lucy Elcoat-Dean <lucy.elcoat-dean@watermangroup.com>
Subject: Canford EfW - Pre-planning enquiry

[EXTERNAL EMAIL] DO NOT CLICK links or attachments unless you recognise the sender and know the content is safe.

Good morning,

Our client is looking to develop an Energy from Waste (EfW) site, as per the attached planning liaison application form.

Please can you advise on whether there is capacity within the WW network to receive flows from the site.

Feel free to give me a shout if you need any further information.

Cheers,

Sean

Sean Whelan MCIWEM C.WEM CSci CEng
Senior Flood Risk Engineer
Waterman Infrastructure & Environment Ltd

Pickfords Wharf | Clink Street | London SE1 9DG
t +44 207 928 7888 | d +44 330 060 4343
www.watermangroup.com | [LinkedIn](#) | [Twitter](#) | [YouTube](#)

 Please consider the environment before printing this e-mail. Thank you!



Waterman Group is a multidisciplinary consultancy providing sustainable solutions to meet the planning, engineering design and project delivery needs of the property, infrastructure, environment and energy markets.

This message contains confidential information and is intended only for the individual named. If you are not the named addressee you should not disseminate, distribute or copy this email. Please notify the sender immediately if you have received this email by mistake and delete it from your system. Email transmission cannot be guaranteed to be secure or error-free as information could be intercepted,

corrupted, delayed, lost, destroyed, incomplete, or contain viruses. The sender does not accept liability for any errors or omissions in the contents of this message, which arise as a result of email transmission. All reasonable precautions have been taken to see that no viruses are present in this email. Waterman Group cannot accept liability for loss, disruption or damage however caused, arising from the use of this email or attachments and recommend that you subject these to virus checking procedures prior to use. Email messages may be monitored and by replying to this message the recipient gives their consent to such monitoring.

Waterman Group Plc., Pickfords Wharf, Clink Street, London SE1 9DG, is a company registered in England and Wales with company registration number 2188844.

This email is confidential. If you are not the intended recipient, you must not copy, distribute, disclose or use the information contained in it. If you have received this communication in error, please tell us immediately by return email and then delete the email and any copies of it from your computer system. Thank you.

Wessex Water Services Limited, Registered in England No 2366648. Registered Office – Wessex Water Operations Centre, Claverton Down Road, Claverton Down, Bath, BA2 7WW
