

GENERAL NOTES

ALL ROAD PAVEMENT DESIGN AND CONSTRUCTION WORKS IS TO BE IN ACCORDANCE WITH:
 BS 5948:2010 - ASPHALT FOR ROADS - SPECIFICATION FOR TRANSPORT, LAYING, COMPACTION AND TYPE TESTING PROTOCOL.
 BS EN 13187:2006 - BITUMINOUS MATERIALS.
 DEPARTMENT FOR TRANSPORT MANUAL OF CONTRACT DOCUMENTS FOR HIGHWAY WORKS - VOLUMES 1 & 2 - SPECIFICATION FOR HIGHWAY WORKS (DIT-SHW), LANCASHIRE COUNTY COUNCIL'S SPECIFICATION FOR ESTATE ROADS.

PLAN AREA OF EXTERNAL WORKS IS TO BE STRIPPED OF ALL VEGETABLE, ORGANIC, FOREIGN AND DELETERIOUS MATTER. REFER TO GROUND INVESTIGATION REPORT FOR AVERAGE DEPTH OF UNSUITABLE MATERIAL.
 ALL ARISING THAT ARE TO BE REMOVED FROM SITE SHALL BE DISPOSED OF AT A LICENSED WASTE DISPOSAL SITE. WHERE NECESSARY TEST CERTIFICATES FOR ARISING CONTAINING CONTAMINANTS SHOULD BE SUBMITTED TO THE LICENSED WASTE DISPOSAL SITE FOR APPROVAL AND ACCEPTANCE AS SOON AS IS PRACTICALLY POSSIBLE.

ONCE EXCAVATED THE FORMATION LEVEL MUST NOT BE DISTURBED OR LEFT EXPOSED FOR MORE THAN 24 HOURS. IF THE FOLLOWING SITE ACTIVITIES DO NOT PERMIT THIS THE FINAL 100mm OF MATERIAL ABOVE FORMATION LEVEL SHALL BE LEFT IN-SITU UNTIL THE PROGRAMME IS SUFFICIENTLY PROGRESSSED.

SURFACE COURSE
 MATERIAL = STONE MASTIC ASPHALT
 DESCRIPTION = SMA 10 SURF 40/60
 THICKNESS = 35mm
 AGGREGATE SIZE = 10mm
 POLISHED STONE VALUE = PSV 60
 AGGREGATE ABRASION VALUE = AAV 16
 BINDER = 40/60 PEN PAVING GRADE BITUMEN

BINDER COURSE
 MATERIAL = ASPHALT CONCRETE
 DESCRIPTION = AC 20 DENSE BIN 40/60
 THICKNESS = 60mm
 AGGREGATE SIZE = 6/20mm
 BINDER = 40/60 PEN PAVING GRADE BITUMEN

BASE
 MATERIAL = ASPHALT CONCRETE
 DESCRIPTION = AC 32 BASE 40/60
 THICKNESS = 100mm
 AGGREGATE SIZE = 0/20mm
 BINDER = 40/60 PEN PAVING GRADE BITUMEN

SUB-BASE
 SUB-BASE LAYER SHALL BE A MINIMUM 300mm THICK AND COMPRISE OF A TYPE 1 UNBOUND MIXTURE IN ACCORDANCE WITH THE DEPARTMENT FOR TRANSPORT MANUAL OF CONTRACT DOCUMENTS FOR HIGHWAY WORKS VOLUME 1 - SPECIFICATION FOR HIGHWAY WORKS. IT CAN CONTAIN CRUSHED ROCK, CRUSHED CONCRETE, CRUSHED SLAG, RECYCLED AGGREGATES OR WELL BURNED NON-PLASTIC SHALE AND BE SELECTED, GRADED, LAID AND COMPACTED TO CLAUSE 803 AND TABLE 84 IN ACCORDANCE WITH THE DIT - SHW.

SUB-BASE TO BE LAID UPON TENSAR TRIAX 160 GEOGRID

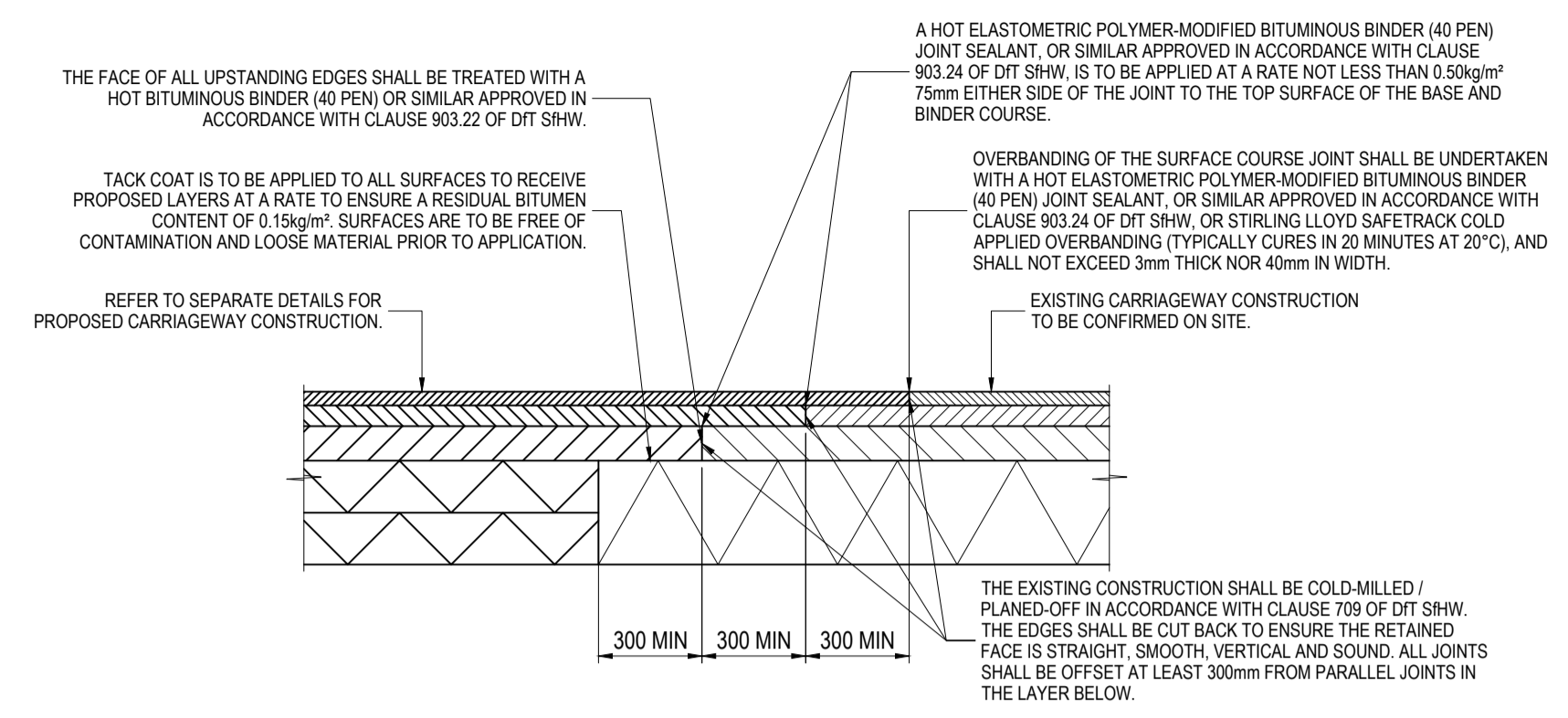

PROPOSED TO EXISTING CARRIAGEWAY TRANSITION JOINT DETAIL
 SCALE 1:20

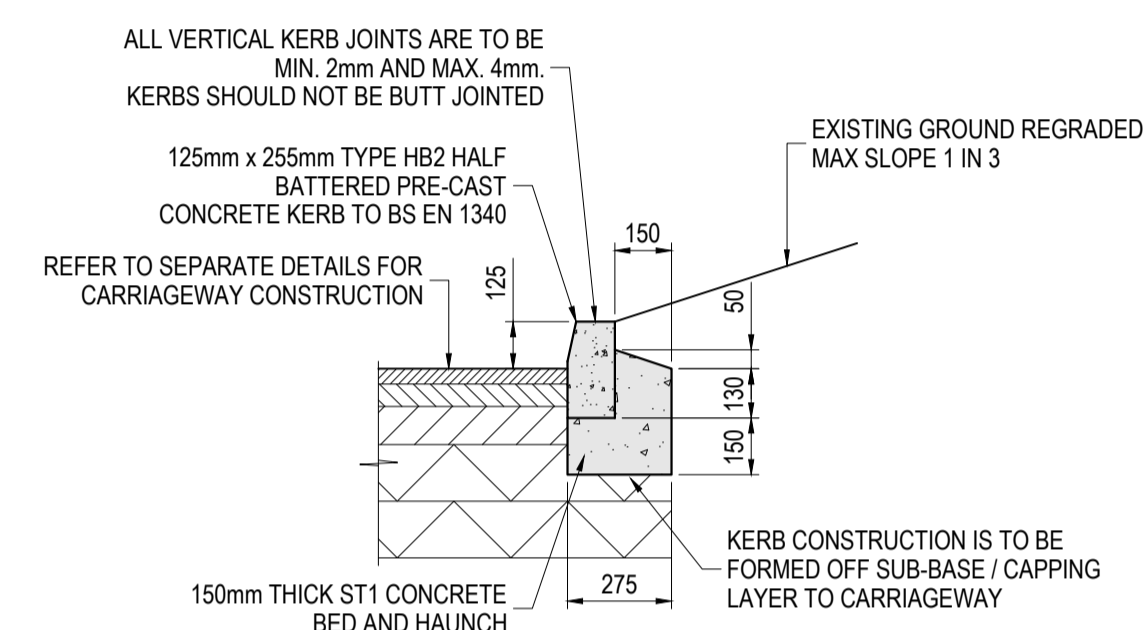

TYPE HB2 HALF BATTERED KERB DETAIL
 SCALE 1:20

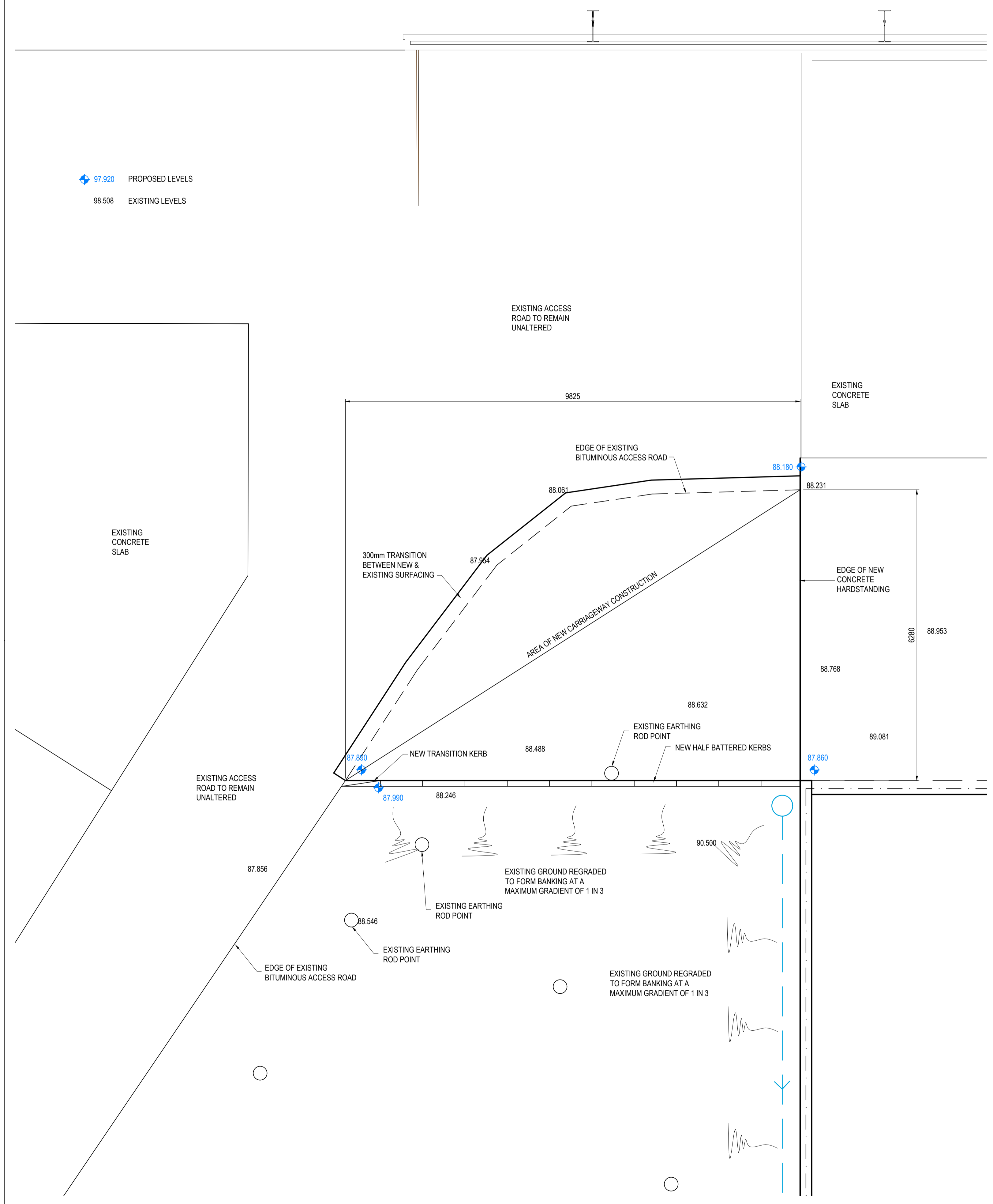

PLAN ON ACCESS ROAD EXTENSION

REV	AMENDMENTS	DATE	INTS
C2	LEVELS CORRECTED TO A.O.D. LEVELS	10.03.20	MB
C1	CONSTRUCTION ISSUE	14.02.20	MB
T2	DRAWING UPDATED FOLLOWING CLIENTS REQUEST	09.07.19	MB
T1	ISSUED FOR COSTING PURPOSES	01.07.19	MB

STATUS		CONSTRUCTION	
 Sleater & Watson LLP 26 West Cliff, Preston, Lancashire, PR1 8HU. Telephone: 01772 821044 E-mail: admin@sleaterwatson.co.uk Website: www.sleaterwatson.co.uk			
CLIENT		T. CLARKE	
PROJECT		CHEMICAL DELIVERY AREA CTF BUILDING BAE SAMLESBURY	
DRAWING TITLE		EXTERNAL CHEMICAL DELIVERY AREA ACCESS ROAD EXTENSION	
DRAWN	M BILLINGTON	CHECKED	
DATE	01.07.19	SCALE@A1	1:50
DRAWING NUMBER	218/69/11		REV C2